

epa<sup>therm</sup> indoor climate boards are ecofriendly and can be proceeded easily. They help reduce energy costs and create a salubrious climate.

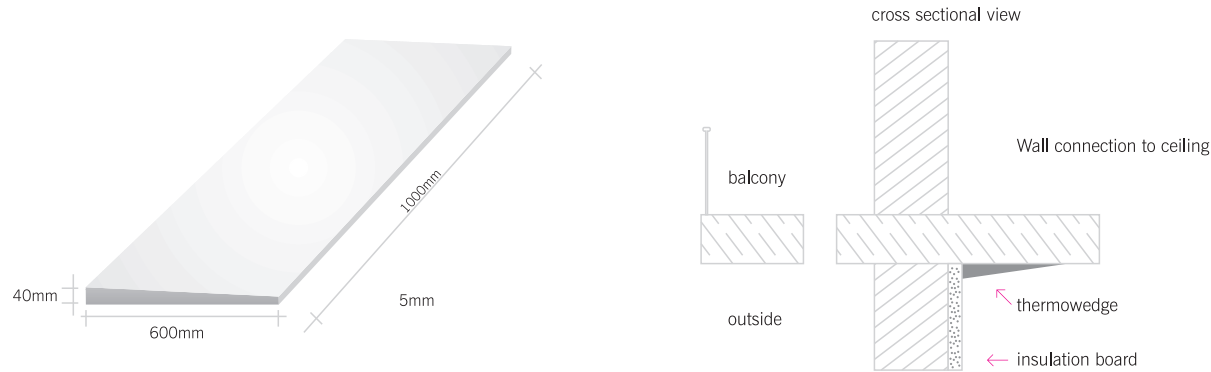

→ Thermowedge: The elegant solution for ceiling and wall



→ Board sizes

INDOOR CLIMATE BOARDS	
Size	100 cm x 75 cm
Thickness	3 cm or 5 cm *
REVEAL BOARDS	
Size	100 cm x 24 cm
Thickness	2 cm
THERMO WEDGES	
Size	100 cm x 60 cm
Thickness	wedge-shaped from 4.0 cm to 0.5 cm

\* custom made thickness from 2 cm - 18 cm available

→ Properties

- health promoting
- climate regulating
- insulating
- bioresistant
- pressure resistant
- incombustible
- noise reducing
- easy to proceed
- ecofriendly
- suitable for allerysufferers
- purely mineral
- free of cement

→ Application fields

- thermal insulation
- dry wall installation
- mould sanitation
- attics, basement rooms, bathrooms, sleeping rooms, fitness rooms, home offices
- offices, stores, archives, libraries
- schools, kindergartens

Technical data:

Apparent dry density	ca. 290	kg/m <sup>3</sup>
Porosity	ca. 90	Volumen-%
Cappillar water absorption	ca. 270	Mass-%
	ca. 26	kg/m <sup>2</sup>
Water vapour absorption	> 30	Mass-%
	ca. 1,5	kg/m <sup>2</sup>
pH-value	ca. 10,5	-
Fire behaviour DIN 4102	Class A1	incombustible
μ-value	5	-

→ Problems with mould and moisture ?

We care for healthy conditions in your rooms... For 50 years now!



## → Important to know...



# That's the way to do it!

### The nuisance

Problems caused by humidity and mould are no rarity today, as many people know.

### The problem

Wet wall zones are excellent agars for mould and algae. Mildew is not only disgusting but also causes diseases like allergies and dyspnoea. Aflatoxins are even rated to cause cancer.

### The cause

Daily experience proves that mould damages are mostly caused by condensed moisture.

### The explanation

Warm air accumulates more water vapour than cold air. When warm and wet air cools down, tiny drops of water arise. In nature this effect leads to fog and dew, which is comparable to the room climate situation.

Cold wall zones are caused by wet masonry, deficient heating, insufficient wall insulation or thermal bridges.

In an average household usually about 15 litres of water vapour are produced by the occupiers, animals, by cooking, showering, dishwashing and watering the flowers. This water vapour is absorbed to the room air.

Of course the moisture is absorbed and reabsorbed by carpets, curtains, furniture, plaster and wall papers, but this has negative effects to all those materials.

Even in rooms with adequate thermal insulation condense water can arise behind cupboards, cabinets and thicker curtains, because the room air cannot warm up sufficiently. Particularly prone to this are wall edges and reveal zones, as they cool down quickly.

### The solution

Moisture and mould can be prevented by the combination of an effective insulation and climate regulation. *epatherm* indoor climate boards balance temperature and moisture differences perfectly. Exceeding moisture in the air of a room cannot condense at the wall surface, but is absorbed in the pores of the board. As soon as the room climate has normalised, the moisture is released back. The boards surface remains dry and free of mould.

### The characteristics

*epatherm* indoor climate boards are purely mineral and consist of lime, quartz sand and water. They are incombustible and have excellent noise reducing effects.

A high pH-value prevents from any new mould.

### The advantages

*epatherm* indoor climate boards are ecofriendly and can be proceeded easily. They help reduce energy costs and create a salubrious climate.

MOISTURE



CONDENSE WATER

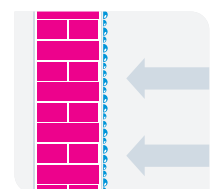

MOULD



THE SOLUTION: *epatherm*

